



GORDON BELL HIGH SCHOOL ON-LINE REGISTRATION PREP & COURSE SELECTION PLANNING

Target Audience:

Present Grade 9, 10, 11
and returning Grade 12 Students

Registering for: 2026 - 2027

THE HIGH SCHOOL CREDIT SYSTEM



- ☐ You need a minimum of 30 credits to graduate and receive a “Senior Years” High School Diploma.
- ☐ You begin receiving credits in Grade 9.
- ☐ These can be a mix of regular, modified and/or EAL credits.

COMPULSORY (MANDATORY) CREDITS PER GRADE

Grade 9 (6)

- ☐ English
- ☐ Reading is Thinking(GB)
- ☐ Math
- ☐ Social Studies
- ☐ Science
- ☐ Physical Education (Phys. Ed.)

Grade 10 (6)

- ☐ English
- ☐ Reading is Thinking (GB)
- ☐ Math (Intro Applied /Pre-Cal, Essentials)
- ☐ Science
- ☐ Phys. Ed.
- ☐ Geography

Grade 11 (4)

- ☐ English (Comprehensive, + Trans, or Lit option)
- ☐ Math (Pre-Cal, Applied, Essentials)
- ☐ Phys. Ed.
- ☐ Canadian History

Grade 12 (4)

- ☐ English (Comp, + Literary and/or Transactional)
- ☐ Math (Pre-Cal, Applied, Essentials)
- ☐ Phys. Ed.
- ☐ Global Issues (GB)

Total compulsory (mandatory) courses at Gordon Bell for all students: 20

ELECTIVES (OPTION COURSES)

- 9 can be at any grade level
- 1 must be at the Grade 11 level (30 level)
- 2 must be at the Grade 12 level (40 level)

NOTE: If going to University you will need 3 Grade 12 electives

Examples: Dance, Biology, Art, Foods, Psychology, etc.

- ✓ Try to sign up for courses you are interested in!
- ✓ Consider post-secondary requirements!

Total electives (option) courses: 12





UNDERSTANDING COURSE CODES

Each course consists of a **course code**, followed by a **number** and a **letter** (ex. **ESMR3S**)

- ❑ The **COURSE CODE** (ex: ESMR) is an abbreviated form of the course name (ex: Essentials Math)
- ❑ The **NUMBER** tells you the grade level (ex: ESMR3 = Grade 11):
 - 10 is Grade 9
 - 20 is Grade 10
 - 30 is Grade 11
 - 40 is Grade 12
- ❑ The **LETTER** tells you what type of course it is: F is foundation, G is general, S is specialized, E is English as an Additional Language (EAL) (ex: ESMR3S = specialized)

COURSE CODE EXAMPLES

ENGR1F: English, Grade 9 level, Foundation

IAPR2S: Intro to Applied/Pre-Cal Math, Grade 10 level, specialized

GRAR2G: Graphics, Grade 10 level, general

ENGC3S: English Comp, Grade 11 level, specialized

BIOR4S: Biology, Grade 12, specialized

PREREQUISITES



- ❑ Some courses require that you complete a “prerequisite” course prior to being able to take it.

For example, you **MUST** take: Math 10F before Essentials Math 20S

Physics 30S before Physics 40S

- ❑ Many option courses do not have a prerequisite.
- ❑ Sometimes it is recommended to take the prerequisite. Ex: French 10 before grade 11 level
- ❑ Generally, if you are in Grade 10, you will be in Grade 10 option courses.
- ❑ **If you are planning to take Biology, Chemistry and / or Physics you will need to plan ahead!**
 - Ex: In grade 10, students could take:
 - Grade 10 Science in Semester 1
 - Grade 11 Physics and / or Chemistry in Semester 2

WHICH MATH OPTION DO I CHOOSE IN GRADE 10?

In Grade 10, there are two different Math options:

☐ Essential Math (ESMR)

- Take if your post-secondary planning is geared toward Law, Humanities (History, English, Political Studies, Criminology, Psychology, etc), Architecture, Kinesiology, Environmental Studies, Art, Music or Social Work
- If you choose Essential Math you cannot take Applied Math or Pre-Calculus Math.

☐ Intro to Applied Pre-Calculus Math (IAPR2S)

- Keeps all of your post-secondary doors open
- Need to be fairly strong in Math and have a good work ethic.

Take IAPR2S if you are studying to become one of the following:

→ DOCTOR, ENGINEER, ACCOUNTANT, DENTIST, PHARMICIST, MANY SCIENCE RELATED FIELDS (i.e. FOOD SCIENCE, AGRICULTURE, CHEMISTRY, PHYSICS) or going into BUSINESS SCHOOL

Refer to Math Info Sheet on website.

The decision for which math to choose will be made based on your abilities and future career goals. Consult with your math teacher, guardian(s), career advisor and counsellor.

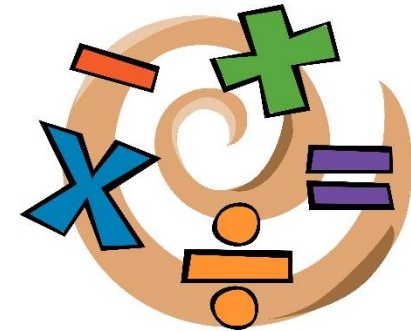

WHICH MATH OPTION DO I CHOOSE IN GRADES 11 & 12?

There are three different Math options:

☐ Essentials Math (ESMR)

- Take if your post-secondary planning is geared toward Law, Humanities (History, English, Political Studies, Criminology, Psychology, etc), Architecture, Kinesiology, Environmental Studies, Art, Music or Social Work
- If you choose Essential Math you cannot take Applied Math or Pre-Calculus Math.

☐ Applied Math (APMR)

- Take if your post-secondary plans do not require a study of theoretical calculus.

☐ Pre-Calculus Math (PCMR) *Keeps ALL of your post-secondary doors open!

- Take if your post-secondary plans involve studying calculus and related mathematics.

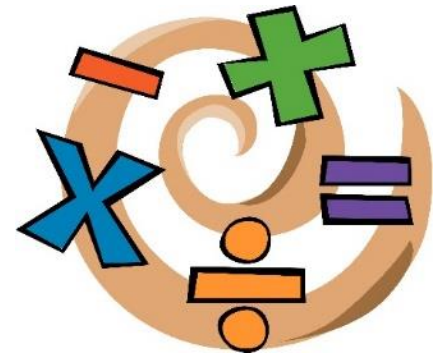

Grade 10 Intro to Applied & Pre Calculus Math 20S (IAPR2S) is the mandatory prerequisite for Pre-Calculus and Applied Math!

PLEASE NOTE: You must take Applied Math or Pre-calculus Math if you are planning to become one of the following:

→ DOCTOR, ENGINEER, ACCOUNTANT, DENTIST, PHARMICIST, MANY SCIENCE RELATED FIELDS
(i.e. FOOD SCIENCE, AGRICULTURE, CHEMISTRY, PHYSICS) or going into BUSINESS SCHOOL.

WHICH ENGLISH DO I CHOOSE?

(STARTING IN GRADE 11)



☐ English Comprehensive (Comp) (ENGC):

- **English Comp is compulsory for Grade 11s and 12s**
- Focus: reading and writing **a variety of fiction and non-fiction texts**, with various purposes (i.e. to inform, to entertain, etc.)
- A balance of both English Literary and English Transactional

☐ English Literary (Lit) (ENGL): **(can take as an elective)**

- Focus: literature as an artform - interpreting, reading, and writing short stories, novels, poems, and plays

☐ English Transactional (Trans) (ENGT): **(can take as an elective)**

- Focus: reading and writing of **informative, persuasive, and analytical texts**

Grade 12 students are strongly encouraged to take two English courses.

Refer to English info sheet on school website for more information.

TO CONSIDER AS OF GRADE 10: UNIVERSITY/COLLEGE ENTRANCE REQUIREMENTS

□ Each university or college program has its own special set of general entrance requirements and minimum grade averages (approx. 65-70%) for regular entry

- University: at least 5 credits at the Grade 12 level including English and Math.
 - U of M: 4 must be S level from a set list
 - U of W: 3 must be S level
 - RRC: Varies by program (Pay close attention to admission requirements.)



UNIVERSITY
OF MANITOBA



Please Note: Other than EALR4S (English for Success); E level credits are not accepted

If English is not your first language, you may be required to meet Special Language requirements.

□ Certain post-secondary programs require that you take specific high school courses to get in
i.e.: Paramedic program at Red River requires Grade 11 Biology among other courses

To become a doctor, you must take Pre-Cal Math, Biology, Chemistry and Physics



****It is important for you to start considering what program/field of study you want to pursue after high school BEFORE registering for Grade 10 Math and Grade 11 classes.**

Refer to the Post-Secondary Requirements Info Sheet on the school's website.

PLEASE GIVE STUDENTS A COURSE PLANNING SHEET



ELECTIVES (OPTION COURSES) OFFERED AT GORDON BELL

- There are no prerequisites, but students are encouraged to take courses in order!
- Make a note of the ones that interest you the most.

Students will be required to choose 5 option courses.



WHICH OPTIONS DO I CHOOSE?



- List in order of priority (1 = the one you want the most)
- Don't worry which courses your friends are signing up for!
- Take courses you are interested in or are passionate about!
- Try something new! You may reveal a hidden talent!
- Be mindful of post-secondary prerequisites!

LANGUAGES

☐ French (FRER)

Want a stronger brain?
Speak a second language!



10

BENEFITS OF LEARNING A NEW LANGUAGE

1. Boosts brain power
2. Improves memory
3. Sharpens the mind
4. Enhances decision making
5. Your first language is improved
6. Improves academic performance
7. Increases networking skills
8. Provides better career choices
9. Enhances ability to multitask
10. Keeps the mind young and active

SPECIAL LANGUAGE CREDIT

Receive up to 4 credits for a language you already know!

- ❑ Each year there are two opportunities to write a **special language exam** (in the Fall/Winter and in the Spring).
- ❑ See a counsellor or Ms. Lockhart for more details.





— William Shakespeare, *Hamlet*

- English Lit (Grade 11 & 12) (ENGL)
- English Trans (Grade 11 & 12) (ENGT)
- English for Academic Success (Grade 12) (EALR) for Language Learners

(Reminder – Comp is mandatory in both Grade 11 and 12

Speak with your English Teacher or refer to the English Information sheet on the school's website for more details.

READING IS THINKING (RITR)

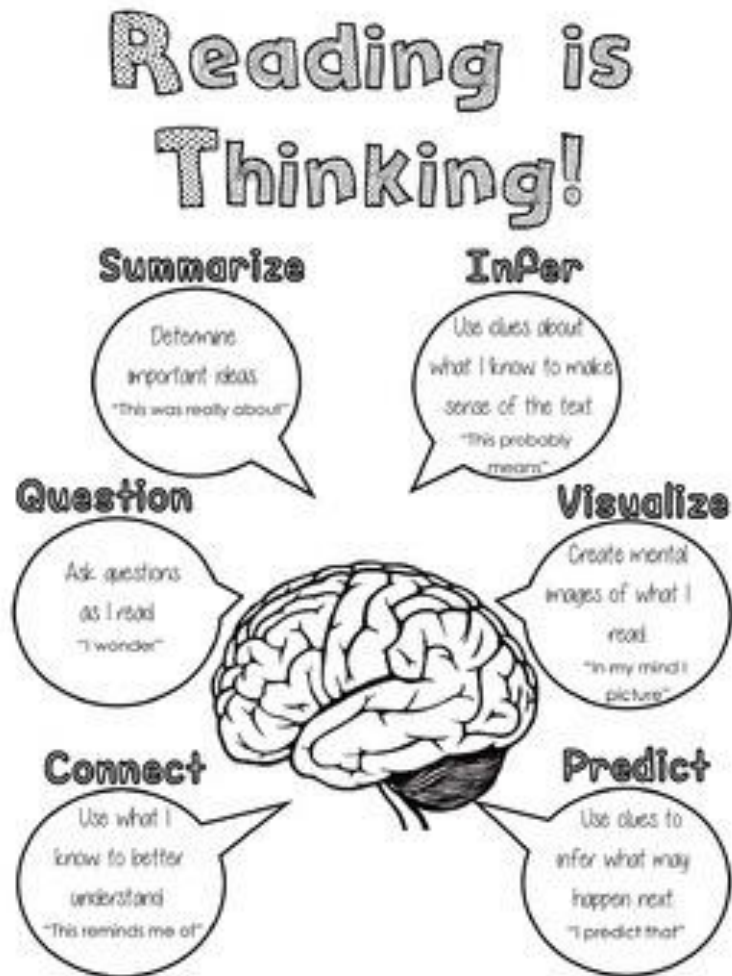

❑ Learn, practice, and internalize strategies that are essential life-long skills for proficiency in reading, writing, understanding and interpreting content specific materials

❑ Literacy strategies will be applied across content areas (English, Math, Science, Social Studies, etc.)

❑ Course is Pass / Fail

❑ Forms part of your English courses in grades 9 and 10. Offered as a separate course in grade 11

- ❑ Psychology (PSYR4S))
- ❑ Cinema as a Witness to Modern History (CMHR4S)
- ❑ Law (LAWR4S)

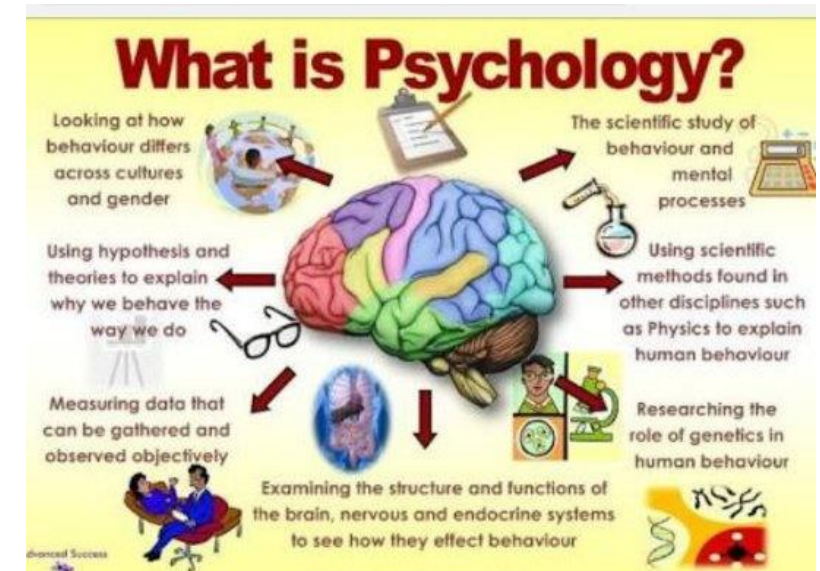

APPLIED TECHNOLOGY:

□ Graphic Arts (GRAR)

Design, layout and typography, Adobe Photoshop, Adobe Illustrator, sign production to multi-coloured decals and banners, screen-printed shirts

□ Introduction to Drone Technology – Grade 11 (ELER3G)

Flight practice, simulators, and design challenges while exploring real-world applications such as environmental monitoring and search and rescue.

□ Electronics & Electrical Technology (ELER2G)

The fundamentals of electronics through hands-on circuit building and testing. Students work with components, breadboards, multimeters, and soldering tools to design and build electronic systems, including control projects

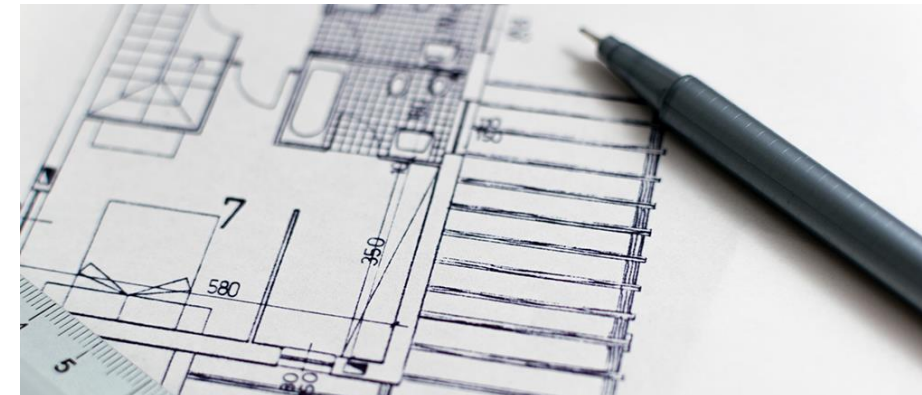



- ❑ **Human Ecology(HECR):** integrates key concepts from Family Studies, Food & Nutrition, and Textile Arts & Design. Students will explore personal goal setting, decision-making and budgeting while examining the influence of social media and marketing on individual and family choices. The course emphasizes the development of essential life skills, including basic nutrition knowledge, practical food skills, and creative design processes, to support informed, healthy, and responsible living.
- ❑ **Foods and Nutrition (FNUR):** focuses on the individual and the influence that marketing and media have on food choices and their impact on health and well-being. his course provides opportunities for students to apply food preparation skills in a practical cooperative group setting.
- ❑ **Environmental Design (ENDR):** Designing and caring for outdoor spaces through classroom learning and hands-on work in the school greenspace. Students apply design principles while planting, propagating, and maintaining gardens, native plant areas and food-growing spaces, building skills connected to horticulture, sustainability, and environmental stewardship.



FINE ARTS

☐ Visual Arts (VIAR)

☐ Senior Band (MCBR) (rehearsals at lunch)

☐ Choir

-Senior Choir (MCCR) (rehearsal during the lunch hour - TBD)

-Auditioned Chamber Choir (MCER): **VOX** (rehearsal at 7:50a.m. on odd days - TBD)

☐ Dance

-Dance class (DANR)

-Auditioned ensemble: Urban Fusion (DN1R) (Mondays at lunch and Wednesdays 3:30-5:00 p.m. - TBD)

☐ Drama (DAMR)

You can earn an additional ½ credit in Drama Performance (DPHB) if you are accepted as part of the school's Auditioned Production (auditions begin in November, rehearsals November – March, performances in early March!

☐ Guitar (MGUR) (at Grades 10 & 11 level only)

☐ Piano (MMKR) More independent in style (not an ensemble credit)

☐ Musical Theatre (MU1R) Available at grade 10, 11 and 12 levels.





- ## Pay attention to university prerequisites!

Speak with your teachers and refer to the Handbook

for more information.

- ☐ Exercise Science (EXSR4S) - Additional phys. ed course available at the grade 12 level.

INDIGENOUS ENTREPRENEURSHIP

-VENTURE DEVELOPMENT-

VDER3S & TTBR4S

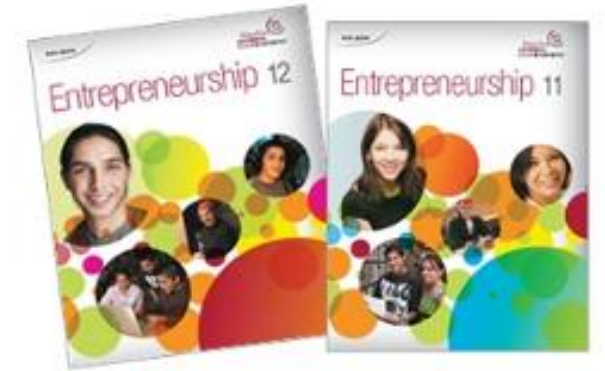

Note: Grade 11 class is a prerequisite for the Grade 12 class.

- open to self-identified Indigenous or Métis students
- Develop your ideas into a full-on business plan!
i.e. research, social media, budgeting, marketing, pricing, implementing, etc.
- Connections to local/national businesses
- Small class sizes

CAREER EDUCATION — LIFE/WORK

- ☐ Life/Work Planning (LWER1 S)
- ☐ Life/Work Planning (LWPR2S)
- ☐ Life/Work Building (LWBR3S)
- ☐ Life/Work Transitioning (LWTR4S)



CREDIT FOR WORK EXPERIENCE



Receive up to 2 credits for paid employment!

- ☐ There is paperwork to fill out **BEFORE** beginning and **AFTER**.
- ☐ You must also track your hours.
- ☐ You must complete a minimum of 110 hours for a full credit or 55 hours for one half credit.
- ☐ **You must also enrol in, or have already completed at least a .5 credit of Lifeworks.**

COMMUNITY SERVICE CREDIT (VOLUNTEER CREDIT)



Receive one credit for volunteering!

- ☐ There is paperwork to fill out **BEFORE** beginning.
- ☐ You must also track your hours.
- ☐ You must complete a minimum of 110 hours for a full credit or 55 hours for one half credit.
- ☐ You cannot be paid for your volunteer hours.
- ☐ You can begin your hours in Grade 9 or 10 and continue right until Grade 12, or you can finish them more quickly.

NOTE: You can only earn a maximum of 1 volunteer credit. Counts towards graduation!

CULTURAL EXPLORATION CREDIT

Receive a credit for participating in cultural activities!

- ☐ There is paperwork to fill out **BEFORE** beginning.
- ☐ You must also track your hours.
- ☐ You must complete a minimum of 110 hours for a full credit or 55 hours for one half credit.
- ☐ You cannot be paid for these hours.
- ☐ You can begin your hours in Grade 9 or 10 and continue right until Grade 12, or you can finish them more quickly.



OFF-CAMPUS PRE-APPRENTICESHIP PROGRAM

Electrical Trades Technology

Applied or Pre-Cal Math is required!

CRITERIA:

- ✓ For students enrolled in Grade 11 and 12
(highly motivated, excellent attendance, good people skills)
- ✓ Core classes must be taken during 1st semester of Grade 11 year
and 2nd semester of Grade 12 year
- Math
- English
- Phys. Ed.
- History (Grade 11)



Drop In & Homework Help

Homework Support

Learning Centre – Room 209

Monday to Friday 12:20 to 1:20 p.m.
(every week day) (Lunch hour)



Peaceful Village

All students must go to Room 231 to register!

Monday to Friday 3:30 – 7:00 P.M.
(every week day) (after school)



New Location: Library!

Please see a counsellor in Student Services for a registration form!

COURSE SELECTION PLANNING

The following sheets are available from a counsellor or on the school website under the “School Registration Information” tab to help you with your course selection:

- ☐ Course handbook
- ☐ Course Pre-Selection Planning Sheets
- ☐ Graduation Requirements
- ☐ Math Info Sheet
- ☐ English Info Sheet
- ☐ Post-Secondary Requirements

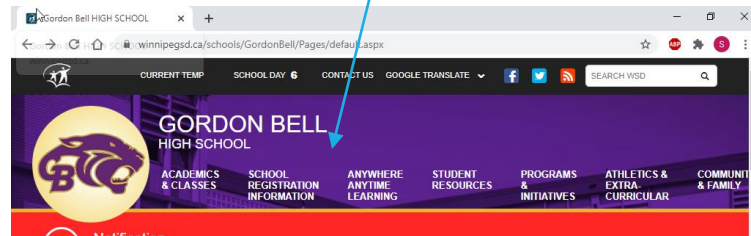

Last Name: _____ First Name: _____
Username: _____ Student Number: _____

2025-2026 Grade 10 Course Selection Sheet

When selecting courses please refer to the course handbook for course descriptions and prerequisites!

COMPULSORY (Mandatory) COURSES FROM GRADE 9				
Do you have all compulsory Grades 9 courses? <u>Circle</u> any missing credits:				
English (ENGR1F)	Math (MATR1F)	Phys Ed. (PHER1F)	Science (SCIR1F)	Social Studies (SOSR1F)
Student will need to register for any of the above missing credits. If you aren't sure, skip this step.				
COMPULSORY (Mandatory) COURSES FOR GRADE 10				
Please put a check mark below beside the course you will need to register for.				
English**	ENGR2F			1 credit
Geography**	GEOR2F			1 credit
Physical Education**	PHER2F			1 credit
Science**	SCIR2F			1 credit
Put a check mark below beside the math course (choose one) you will need to register for.				
Essential Math**	ESMR2S			1 credit
Intro. to Applied & Pre Calculus Math**	IAPR2S			1 credit

Instructions for Selecting Electives (Option Courses):

- Select five (5) electives (option courses) from the list below.
 - Rank courses from 1 to 5. (1 being the one you want most.)
 - Circle the course level. (2 = Grade 10 level, 3 = Grade 11 level, 4 = Grade 12 level)
- Although there are no prerequisites for some courses, it is strongly recommended that students begin with the Grade 10 level. -Students requiring Biology, Chemistry and / or Physics should plan ahead. Begin taking grade 11 science courses in the second semester of their grade 10 year. Students should not leave grade 11 level science courses to their graduating year! -Grade 10 students should not be taking courses at the grade 12 level. Courses are listed so you can see what is available.

Rank	Electives (Option Courses)	Grade 10	Grade 11	Grade 12	credit
	2D Computer Animation / 3D Modeling*	-	ANHR3S / MOHR3S	-	1
	Accounting	-	AEHR3S	ASBR4S	1
	Advanced Math	-	-	ADMHR4S	1
	Art	VIAR2S	VIAR3S	VIAR4S	1
	Band**	MCBR2S	MCBR3S	MCBR4S	1
	Biology**	-	BIOR3S	BIOR4S	1
	Chemistry**	-	CHER3S	CHER4S	1
	Choir**	MCCR2S	MCCR3S	MCCR4S	1
	Cinema as a Witness to Modern History	-	-	CAMHR4S	1
	Current Topics in First Nations, Inuit & Métis Studies	-	-	CTHR4S	1
	Dance	DANR2S	DANR3S	DANR4S	1
	Desktop Publishing / Web Design*	-	DPHR3S / WCHR3S	-	1
	Digital Images / Digital Film*	DHR2S / DPHR2S	-	-	1
	Drama	DAMR2S	DAMR3S	DAMR4S	1
	English Literary**	-	ENGL3S	ENGL4S	1
	English Transactional**	-	ENGT3S	ENGT4S	1
	Family Studies	FSTR2S	FSTR3S	FSTR4S	1
	Food & Nutrition	FNLR2S	FNLR3S	FNLR4S	1
	French	FRER2F	FRER3S	FRER4S	1
	Global Issues	-	-	GLHR4S	1
	Graphic Arts	GRAR2G	GRAR3G	GRAR4S	1
	Guitar	MGUR2S	MGUR3S	-	1
	Introduction to Drone Technology	IDT2G	-	-	1
	Law	-	-	LAWHR4S	1
	Life Work Planning	LWPR2S	LWPR3S	LWTR4S	1
	Musical Theatre	MJLR2S	MJLR3S	MJLR4S	1
	Personal Finance	PFNR2S	-	-	1
	Physics**	PHYR2S	PHYR3S	PHYR4S	1
	Piano	MMHR2S	MMHR3S	MMHR4S	1
	Psychology	-	-	PSYHR4S	1
	Reading Is Thinking	RTR2S	-	-	1
	Textile Arts & Design	TADR2S	TADR3S	TADR4S	1
	Venture Development (Indigenous Entrepreneurship)	-	VDER3S	TTBR4S	1

** Courses may be scheduled at 8:00 a.m., lunch time and / or 2:30 p.m. If you pick band or choir, you will need to pick 4 option courses.

* You will need to take the two half courses to receive 1 credit.

** A prerequisite is required to take this course. (i.e. You must take grade 10 English (ENGR2F) before you can take grade 11 English (ENGR3F) Urban Fusion (ENGR2S, 3S, 4S, 4S), Vocal Jazz (PHYR2S, 3S, 4S) and Drama Performance (DPHR2S, 3S, 4S, 4S) - 1 credit) will be available by audition only and you do not sign up for these at this time.

COURSE SELECTION PLANNING SHEET



When selecting courses please refer to the course handbook for course descriptions and prerequisites!

COMPULSORY (Mandatory) COURSES FROM GRADE 9, 10 and 11

Do you have all the compulsory Grade 9, 10 and 11 courses?

Circle any missing credits:

English (ENGR1F)

Phys Ed. (PHER1F)

Science (SCIR1F)

Social Studies (SOSR1F)

Math (MATR1F)

ENGR2F

PHER2F

SCIR2F

Geography (GEOR2F)

Essential Math (ESMR2S) or Intro Applied Math (IAPR2S)

ENGC3S or ENGT3S or ENGL3S

ESMR3S or APMR3S or PCMR3S

HISR3F

PHER3F

One Grade 11 Option

Student will need to register for any of the above missing credits.

- Circle any credits you are missing
- Don't know? Skip this step – the on-line system will figure it out for you.

COURSE SELECTION PLANNING SHEET

Next, you will see the compulsory courses for your grade level.

COMPULSORY (Mandatory) COURSES FOR GRADE 12			
Please put a check mark below beside the course you will need to register for.			
	English Comprehensive**	ENGC4S	1 credit
	Physical Education**	PHER4F	1 credit
Put a check mark below beside the math course (<u>choose one</u>) you will need to register for. <u>Note:</u> Students can also select additional math courses as electives.			
	Essential Math**	ESMR4S	1 credit
	Applied Math**	APMR4S	1 credit
	Pre-Calculus Math**	PCMR4S	1 credit

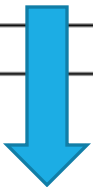

**** means that all previous grade-level prerequisites must be completed before taking this course!**

COURSE SELECTION PLANNING SHEET

- Select the five options you are most interested in taking.
- Remember to number them in order of preference. (1 = the one you want the most)
- You will also need to **circle** the course appropriate grade level.

Rank	Electives (Option Courses)	Grade 10	Grade 11	Grade 12	credit
	2D Computer Animation / 3D Modeling*	-	ANHR3S / MOHR3S	-	1
	Accounting	-	AESR3S	ASYS4S	1
	Art	VIAR2S	VIAR3S	VIAR4S	1
	Band++	MCBR2S	MCBR3S	MCBR4S	1
	Biology**	-	BIOR3S	BIOR4S	1
	Chemistry**		CHER3S	CHER4S	1
	Choir++	MCCR2S	MCCR3S	MCCR4S	1
	Dance	DANR2S	DANR3S	DANR4S	1
	Desktop Publishing / Web Design*	-	DPHR3S / WDHR3S	-	1
	Digital Images / Digital Film*	DIHR2S / DFHR2S	-	-	1
	Drama	DAMR2S	DAMR3S	DAMR4S	1
	English Literary**	-	ENGL3S	ENGL4S	1
	English Transactional**	-	ENGT3S	ENGT4S	1
2	Family Studies	FSTR2S	FSTR3S	FSTR4S	1
	Foods & Nutrition	FNUR2S	FNUR3S	FNUR4S	1
1	French	FRER2F	FRER3S	FRER4S	1
	Global Issues	-	-	GLIR4S	1
	Graphic Arts	GPAP2G	GPAP3G	GPAP4S	1

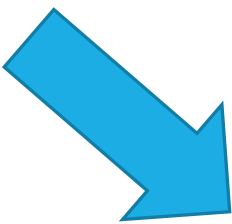

WHEN YOU ARE DONE YOUR PLANNING SHEET...



- ☐ We encourage you to discuss and share your course selections with your parent/guardian.
Continue to consult the documents on the school's website as needed.
- ☐ **Have your planning sheet on you (in your backpack or binder) all this week – starting tomorrow.**
- ☐ On-line registrations will take place later this month. Schedule shared with teachers / posted.
- ☐ Once you have registered on-line, you will receive a paper copy of your official registration.
-Make note of any changes to your personal information (address, phone numbers, etc.)
- ☐ **Registration must be signed by a parent/guardian (or 18+ student)** and returned to the main office no later than.

Don't be disappointed! Save time and frustration!

Get your pre-registrations in early to improve your chances of getting the classes you want!