

Accessing Google Classroom

To access your Google classroom you need to know **your school division account information** that you would have received on your green bookmark when you obtained your school ID. **THIS WILL NOT WORK WITH YOUR PERSONAL GOOGLE ACCOUNTS, YOU MUST USE DIVISION ACCOUNTS.**

To access Google Classroom:

1. Go to <http://classroom.google.com>
2. Enter your school login using the following format: **<your school login> @live.wsd1.org**

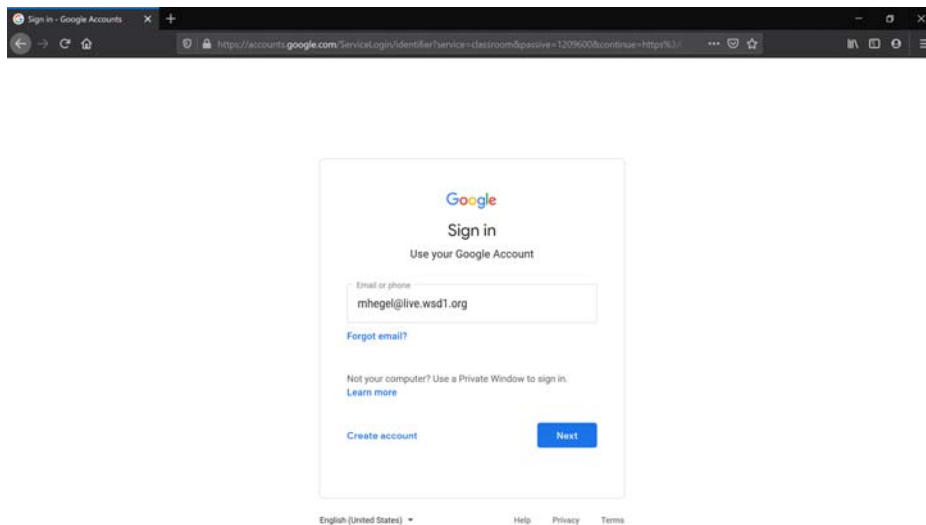

This will redirect you to another login page where you will have to:

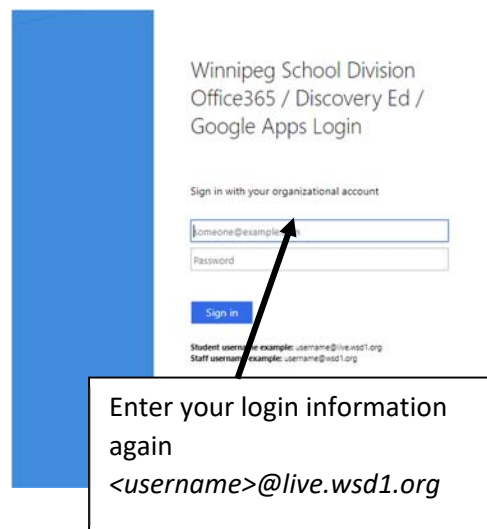
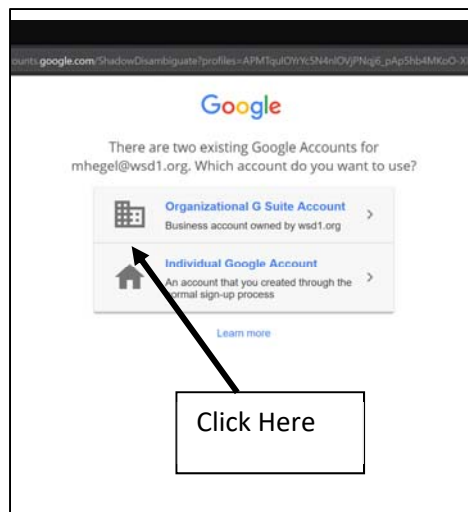

- Re-enter your login: **<your school login>@live.wsd1.org**
- Enter your password: *your student # if you never changed it. Otherwise enter your password.*

3. Once logged in, you will confirm that you have the correct email account.

4. Once you are at the home screen, click on the “+” sign in the upper right-hand corner and enter the Google Classroom Code given to you to join the class:

GOOGLE CLASSROOM CODE: _____

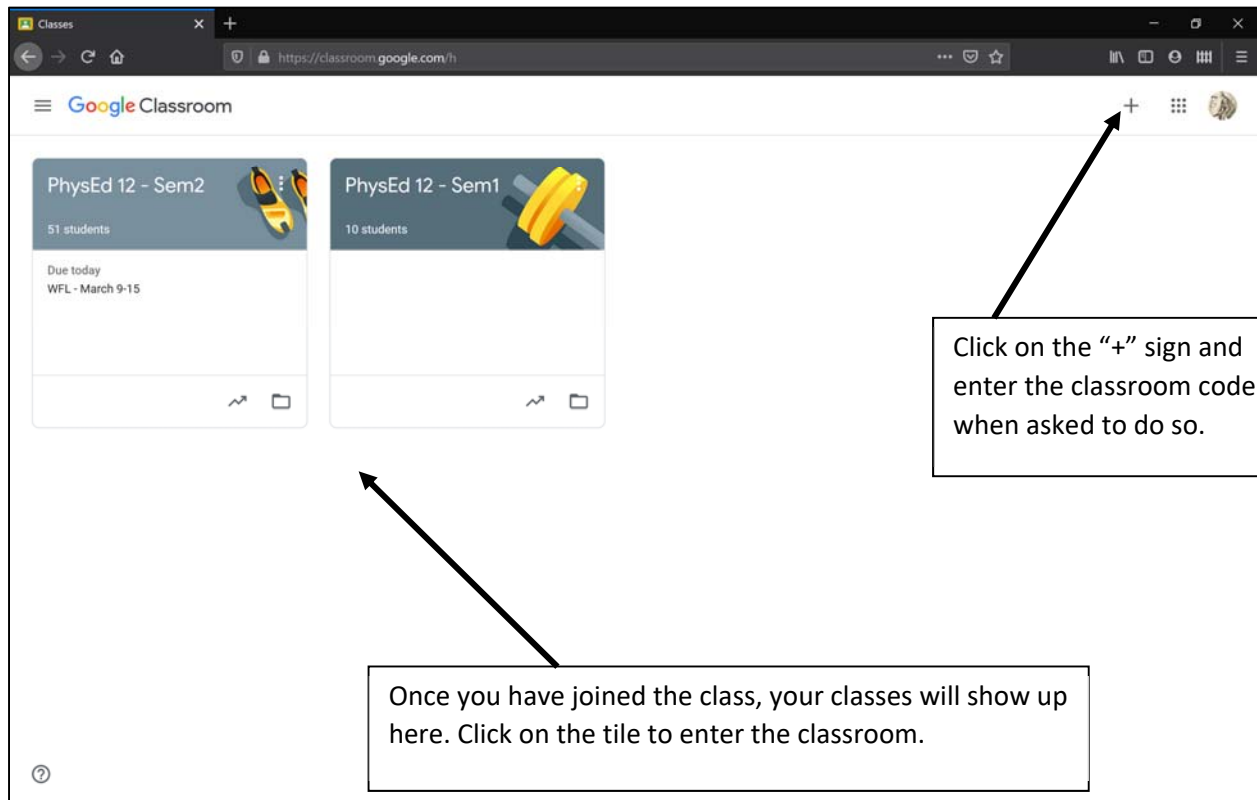

Once you have entered the classroom, your assignments will be found under “CLASSWORK.” All work is automatically saved as you edit. Turn in all assignments on line.

Important Notes:

If you are using on a mobile device, Chromebook, iPad...you will need to download the following apps from you app store to be able to edit locally:

GOOGLE CLASSROOM, GOOGLE DOCS, GOOGLE SHEETS, GOOGLE SLIDES