

OWNER

THE WINNIPEG SCHOOL DIVISION NO.1

ARCHITECT

W.I. ENNS M.R.A.I.C.

CONSULTING ENGINEERS

REID, CROWTHER & PARTNERS LIMITED

DESIGN CONSULTANTS

IKOY PARTNERSHIP

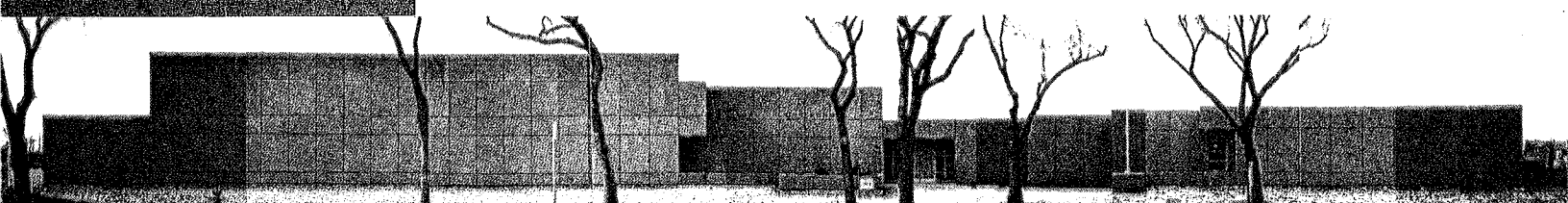

# LORD SELKIRK SCHOOL

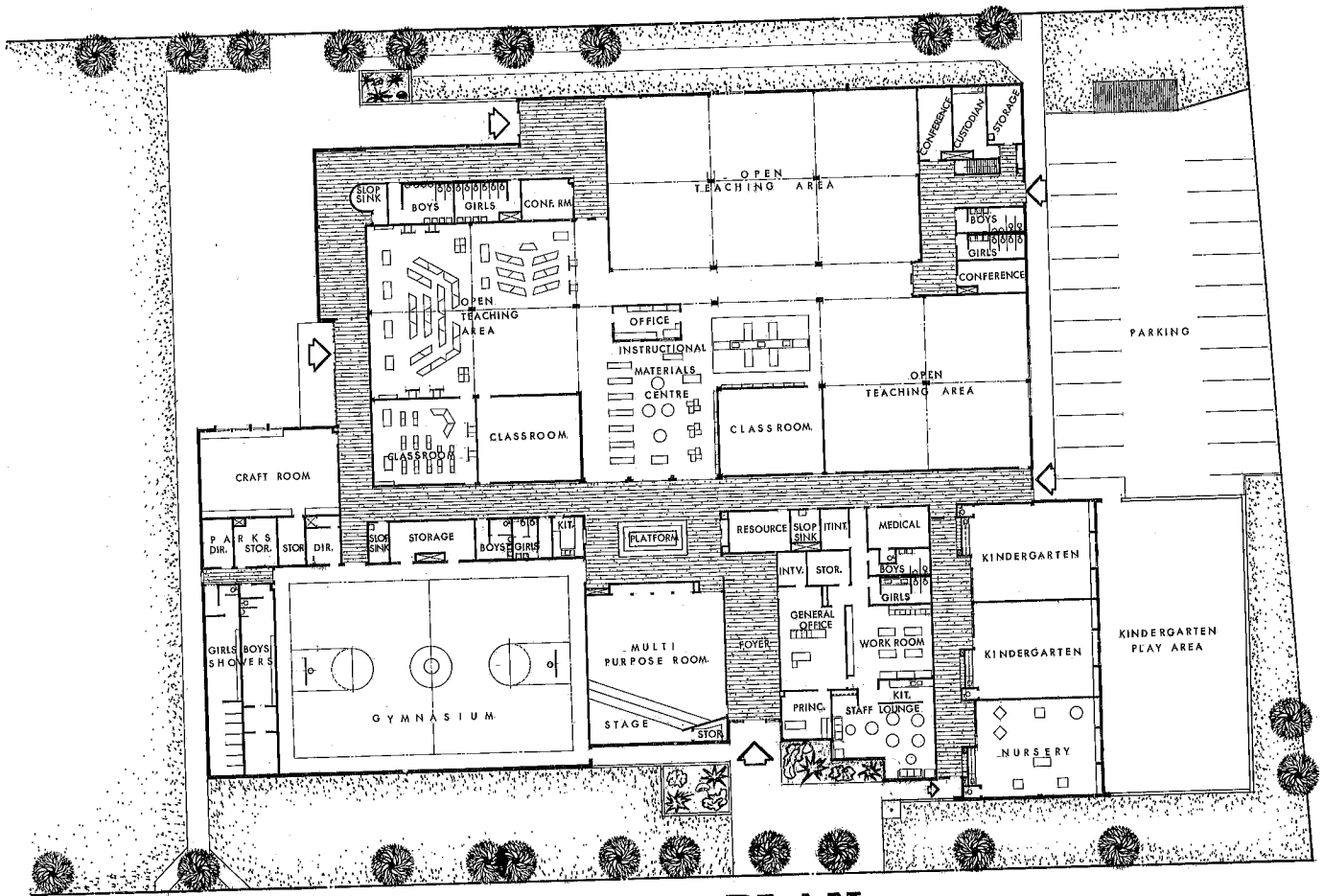

## MAIN FLOOR PLAN

### SCHOOL DATA

Location of School	170 Poplar Avenue - Winnipeg
Date of Construction	1974
Type of School	Elementary
Area of Site	3.66 acres
Area of Building	44790 square feet
Enrolment capacity	575 including 150 early childhood
Net Building Cost	\$1,145,100.00
Square foot cost	\$25.57

## TECHNICAL DATA

BECAUSE OF SPECIAL SOIL CONDITIONS PREVALENT IN THE WINNIPEG AREA, THE FOUNDATION, ALTHOUGH SUPPORTING ONLY A ONE STOREY STRUCTURE, IS A CAST-IN-PLACE REINFORCED CONCRETE PILING SYSTEM USING SULPHATE RESISTING CONCRETE.

THE SUPER STRUCTURE CONSISTS OF A STRUCTURAL STEEL FRAME, STEEL ROOF DECK AND STEEL JOIST AND CONCRETE MAIN FLOOR. EXTERIOR WALLS ARE OF PRECAST CONCRETE WITH AN EXPOSED AGGREGATE FINISH.

ALL INTERIOR WALLS ARE NON-LOAD BEARING AND PARTITIONS SEPARATING INSTRUCTIONAL SPACES ARE DEMOUNTABLE. WALL SURFACES IN THE INSTRUCTIONAL AREAS CONSIST OF VINYL FABRIC ON FIBRE BOARD, THUS PROVIDING A TACKBOARD SURFACE. CARPETING IS USED EXTENSIVELY THROUGHOUT THE SCHOOL BOTH AS AN ACOUSTICAL MATERIAL AND TO LEND WARMTH AND COLOR TO THE DECOR.

THE BUILDING IS COMPLETELY AIR-CONDITIONED. IT IS ALSO EQUIPPED WITH A SMOKE AND FIRE DETECTION SYSTEM WHICH IS DIRECTLY TIED IN TO THE CITY SIGNALS SYSTEM. AN INTERCOMMUNICATION SYSTEM IS ALSO PROVIDED FOR EASIER ADMINISTRATION.

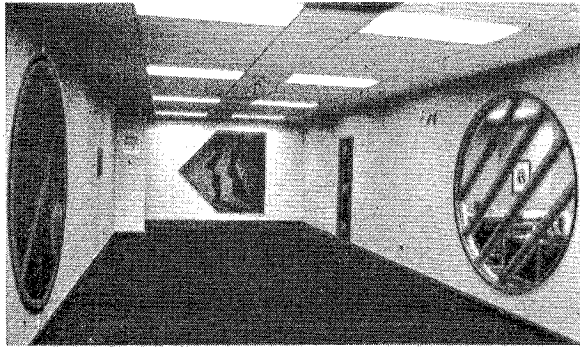

**Foyer**



**Instructional Materials Centre**

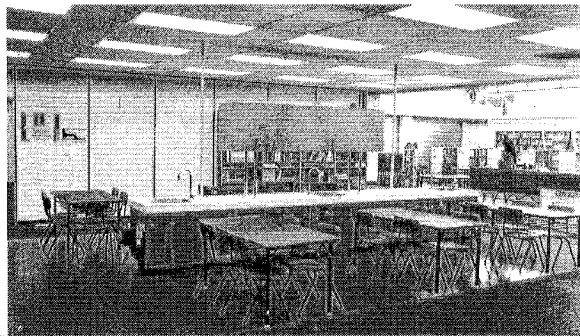

**Science Area**

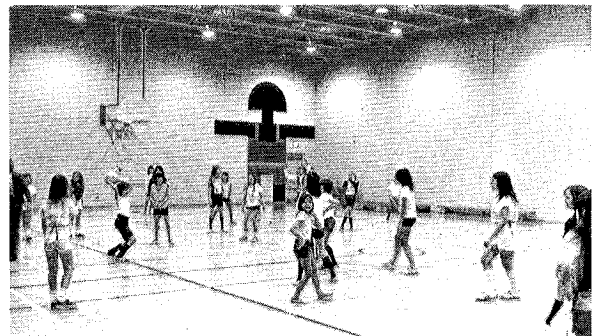

**Gymnasium**